

A. ADJUST WIRES TO THE DESIRED LENGHT / HEIGHT

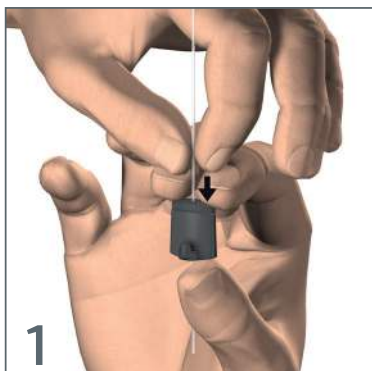

1

Slide the Micro Grip hook on the Twister wire.

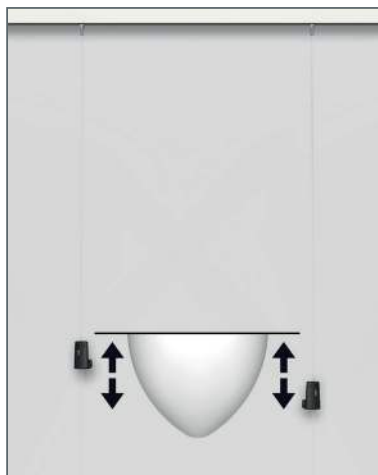
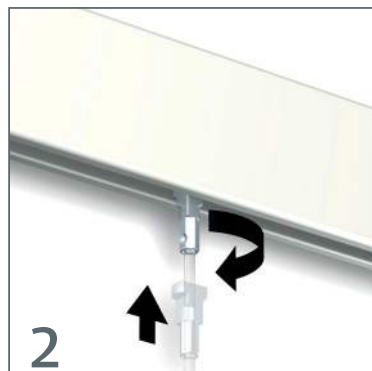

2

Twist&turn both Twister wires with hook in the rail.

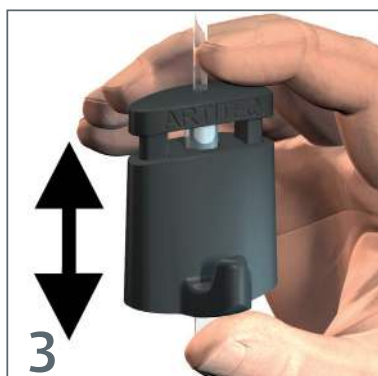

3

Adjust both Micro Grip hooks at the same height.



4

Make sure both hooks are at the desired height.

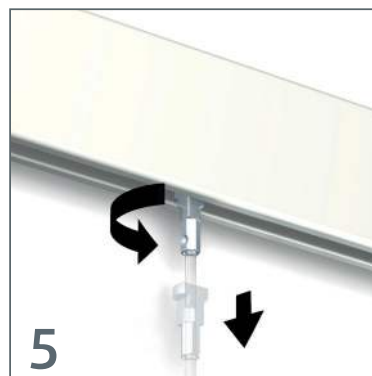

5

Twist&turn both Twister wires out of the rail.

B. HANG BOTANIQ FLOWERPOT



1

Pull the wires from underneath through the opening.



2

Position the hook in one of the 7 holes to lock.

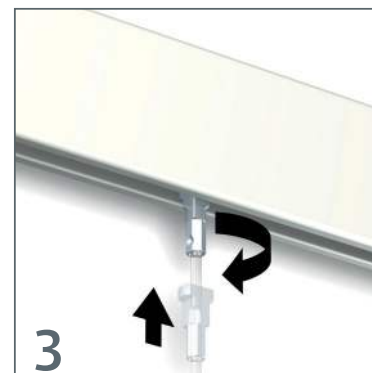

3

Twist&turn both Twister wires in of the rail.



Installation video





4

If desired, adjust the height with the Micro Grip hook.



5

Place plant in Botaniq with flowerpot or soil.



6

Check for tilting of the Botaniq.



7

Tilts forward? Slide hook to pos. 1. Backward? To pos. 7.



8

Botaniq is hanging stable against the wall.



9

Roll the remaining wire and stow behind the Botaniq.

Note: Botaniq can hold 2x 8cm or 1x 10cm flowerpot. Or place the plant directly with soil.

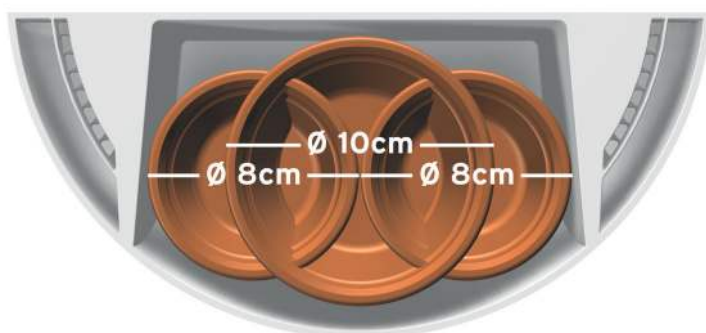

Installation video

